

# Snap A-Frame

## Product Parts (Kit)

- 1 - A-Frame with 2 Single-Sided Installed Posters
- 2 - Snap Edges
- 3 - Side Hinges
- 4 - Acrylic Inserts

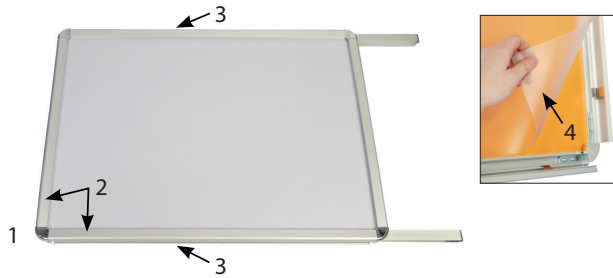

## Display Set-Up

### Step 1

Remove from box and lay on a clean flat surface. Stand A-Frame (1) upright and separate the front and back legs. Push the Side Hinges (3) down to lock the A-Frame (1) in position.



## Graphic Replacement Installation

### Step 1

Open all four snap edges (2) Lift Acrylic inserts (4) and place the graphic in the frame with the Acrylic inserts (4) on top. Close all four snap edges (2).

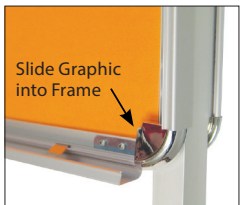

### Step 2

Turn the A-Frame (1) on the other side and repeat Step 1 to install a second graphic.

## Storage

Store in a cool dry location.

## Care

Spot clean with dry cloth for graphics.. Use glass cleaner and wipe with dry cloth for hardware metal and for acrylic inserts.